

IF IN DOUBT PL ASK!

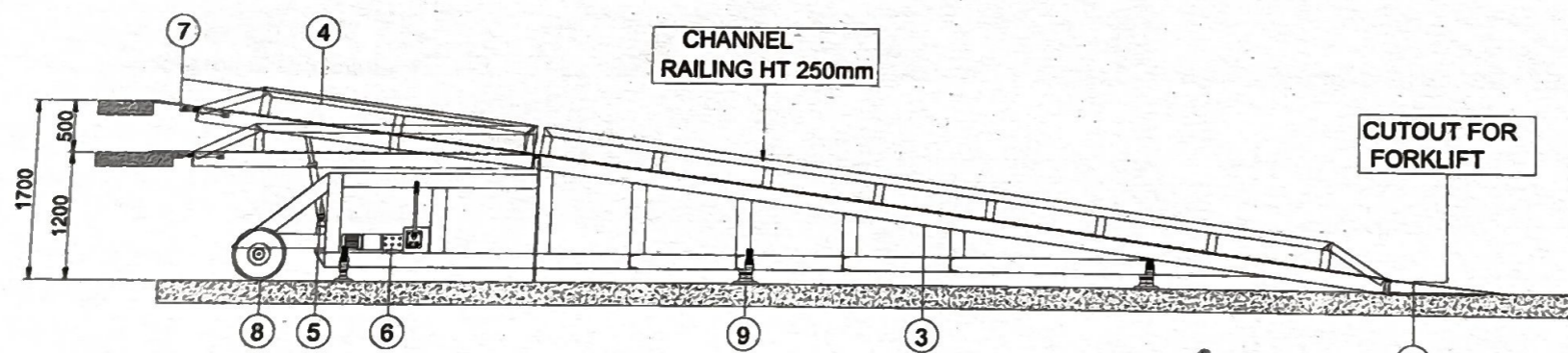

01	CAPACITY	10 TON
02	HINGED FLAP.	
03	FIXED RAMP.	
04	ADJUSTABLE RAMP.	
05	RAMP CYLINDER.	
06	1 HP POWER PACK, CONTROL PANEL HAND PUMP	
07	HYD. FLAP	12mm THK (PLAIN SHEET)
08	SOLID RUBBER WHEEL.	
09	FLOOR LOCK.	
10	MOC	M.S
	STRUCTURE	GOLDEN YELLOW PAINT
11	LOAD CONSIDERED-UNIFORM DISTRIBUTED	
12	DRAWING IS SCHEMATIC ONLY, ACTUAL MACHINE MAY VARY SLIGHTLY.	

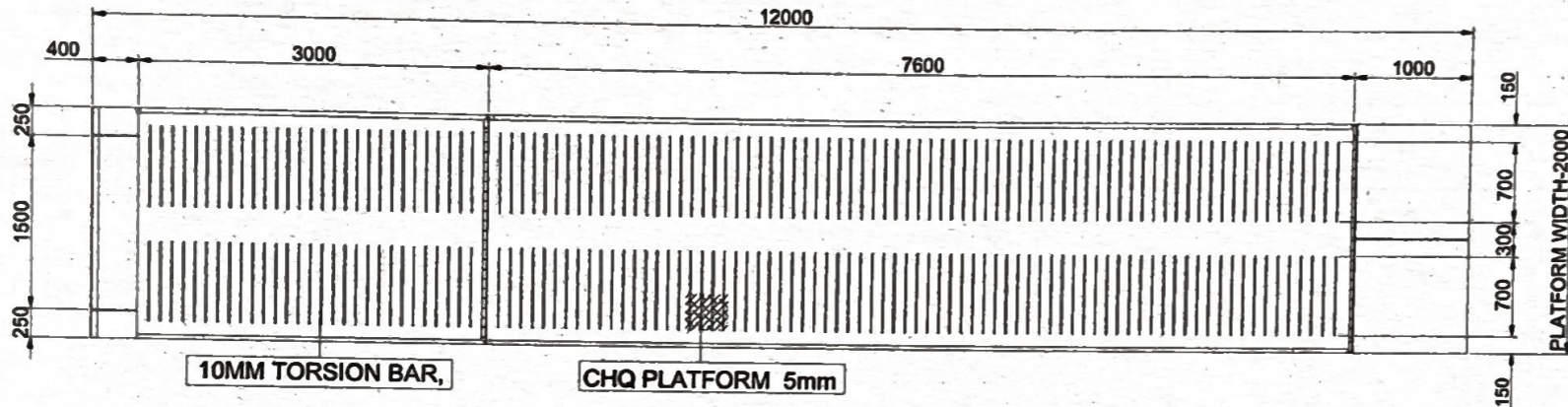
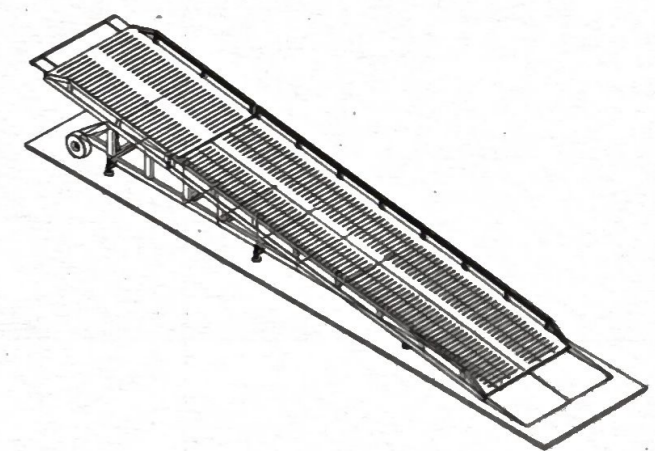

3D VIEW ONLY FOR REF.

10	MOC	M.S
	STRUCTURE	GOLDEN YELLOW PAINT
11	LOAD CONSIDERED-UNIFORM DISTRIBUTED	
12	DRAWING IS SCHEMATIC ONLY, ACTUAL MACHINE MAY VARY SLIGHTLY.	

For ECO WEAVE
Proprietor

ECO WEAVE
ALAPPUZHA
688 006
KERALA
KALATH WARD, AVALOOKUNNU P.O.

CUSTOMER - ECO WEAVE		ALL DIMENSIONS ARE IN mm.		A4
<h1>JOIST-O-MECH</h1> <p>(SINCE 1987)</p>		CO.NO	PRODUCT.NO.	
		DRAWN	S.P	17.08.2020
		CHECKED	LP	17.08.2020
TITLE ELE. HYD. DOCK RAMP		APPROVED	MLH	17.08.2020
		SCALE: NTS		
DRAWING NO.	JUN26-J17-01	SHEET NO.	1-1	REV. RD